

N16 100

SISTEMA DE BATENTE COM RPT

THERMAL BROKEN CASEMENT SYSTEM





Sistema perimetral de construção simples, com uniões à meia esquadria e esquadros de aperto rápido, permite a execução de vãos de grandes dimensões com elevado desempenho funcional.

Com aro fixo de 70 mm, folhas de 79 mm e poliamida de 14,8 mm, possibilita a aplicação de vidros de 12 a 64 mm, com vasta gama de bites para soluções de vidro duplo ou triplo.

Dispõe de câmara europeia normalizada e é compatível com uma ampla gama de acessórios testados e recomendados pela navarra®.

Apresenta elevados desempenhos de permeabilidade ao ar e estanquidade à água, comprovados por ensaios em Organismos Notificados. Disponível em acabamentos anodizados, lacados, bicolor (interior/exterior) e efeito madeira.

Perimeter system with simple construction, featuring mitre joints and quick-clamping brackets, allowing the execution of large openings with high functional performance.

With a 70 mm frame depth, 79 mm sash depth and 14.8 mm polyamide, it allows the application of glazing from 12 to 64 mm, offering a wide range of glazing beads for double or triple glazing solutions.

Equipped with a standard European groove, it is compatible with a wide range of accessories tested and recommended by navarra®.

High air permeability and watertightness performance are proven by tests carried out by Notified Bodies.

Available in anodised, powder-coated, dual colour (interior/exterior) and wood-effect finishes.

ELEVADO DESEMPENHO FUNCIONAL

HIGH FUNCTIONAL PERFORMANCE

FUNCIONALIDADE E ESTANQUIDADE

FUNCTIONALITY AND SEALING

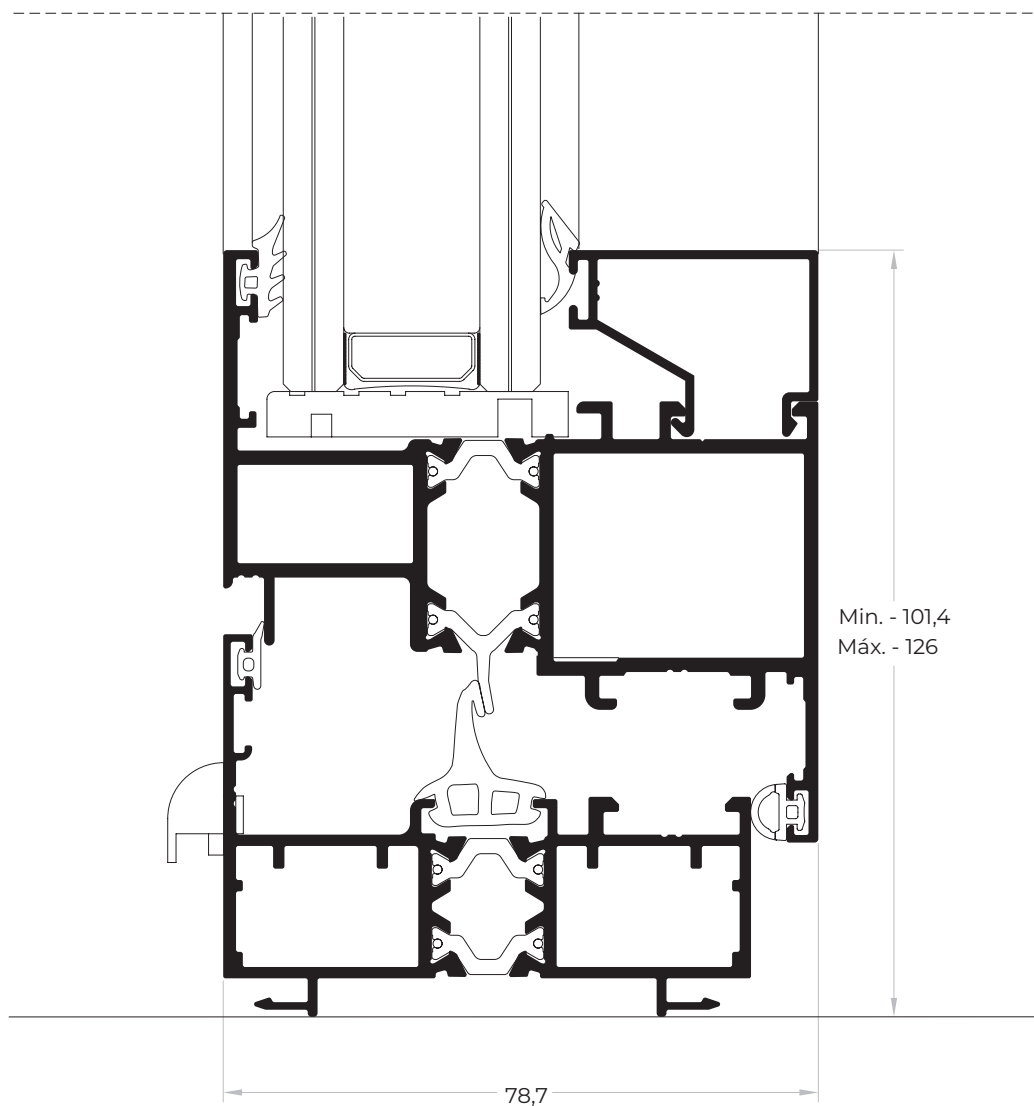



FIXO
FIXED WINDOW

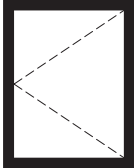

BATENTE
(ABERTURA PARA O
INTERIOR OU EXTERIOR)
SINGLE SIDE HUNG
CASEMENT (INWARD OR
OUTWARD OPENING)

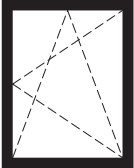

OSCILOBATENTE
TILT AND TURN WINDOW

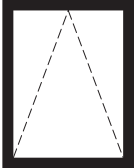

BASCULANTE
BOTTOM HUNG
CASEMENT

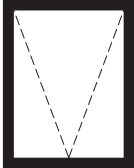

PROJETANTE
TOP HUNG CASEMENT

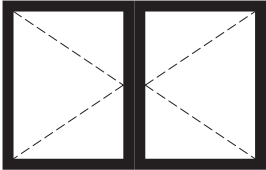

BATENTE 2 FOLHAS
(ABERTURA PARA INTERIOR OU
EXTERIOR)
2 SASHES SIDE HUNG WINDOW (INWARD
OR OUTWARD OPENING)

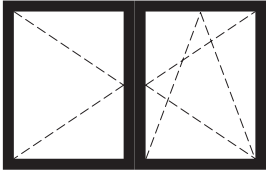

OSCILOBATENTE 2 FOLHAS
2 SASHES TILT AND TURN WINDOW

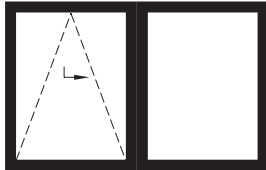

OSCILOPARALELA 2 FOLHAS
(COM FIXO)
2 SASHES TILT AND TURN INLINE SLIDING
(WITH FIXED PART)

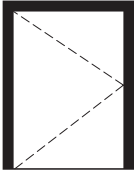

PORTA DE BATENTE
(ABERTURA PARA INTERIOR OU EXTERIOR)
CASEMENT DOOR
(INWARD OR OUTWARD OPENING)

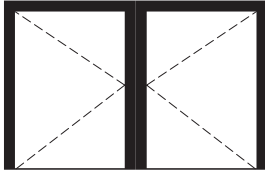

PORTA 2 FOLHAS
(ABERTURA PARA INTERIOR OU EXTERIOR)
2 SASHES DOOR
(INWARD OR OUTWARD OPENING)



MONTAGENS E TIPOLOGIAS ASSEMBLIES AND TYPOLOGIES

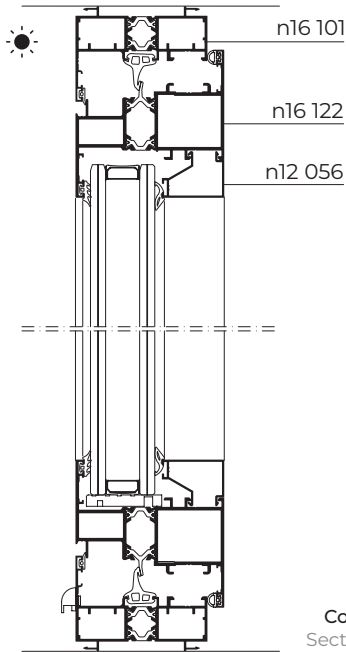

Corte A-A'
Section A-A'

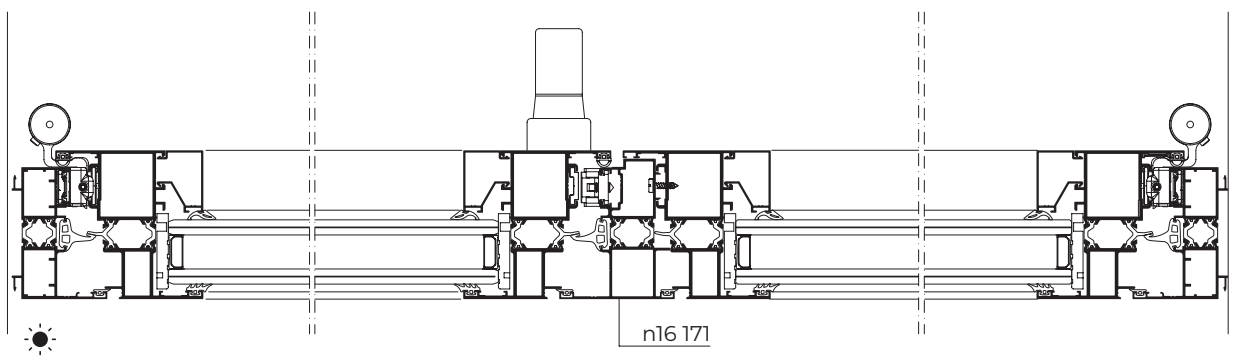
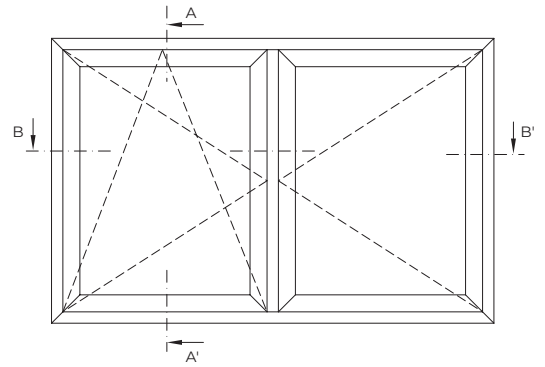

Corte B-B'
Section B-B'

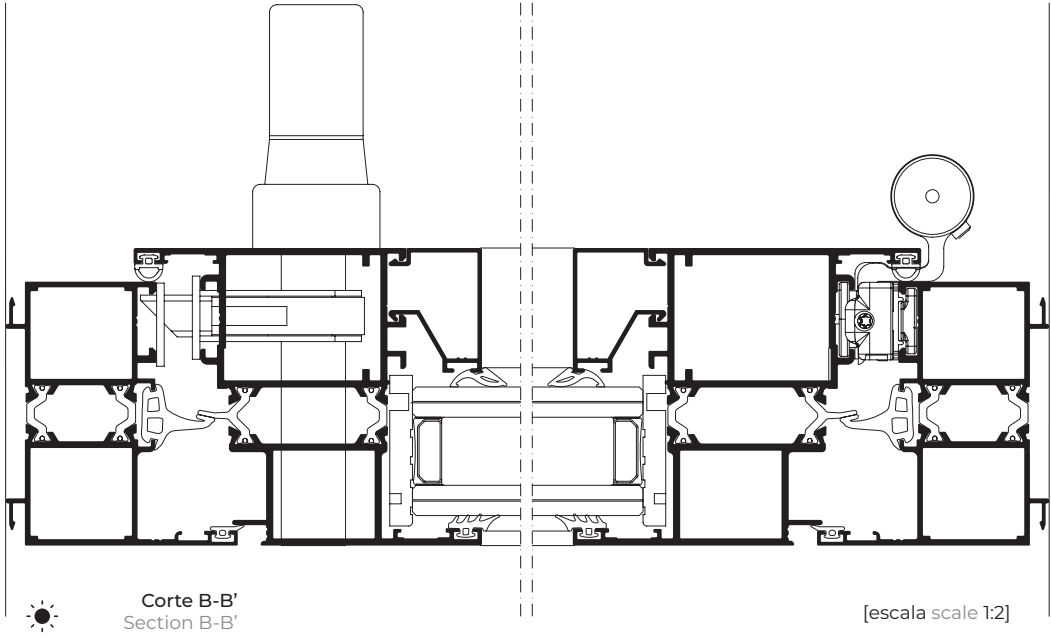
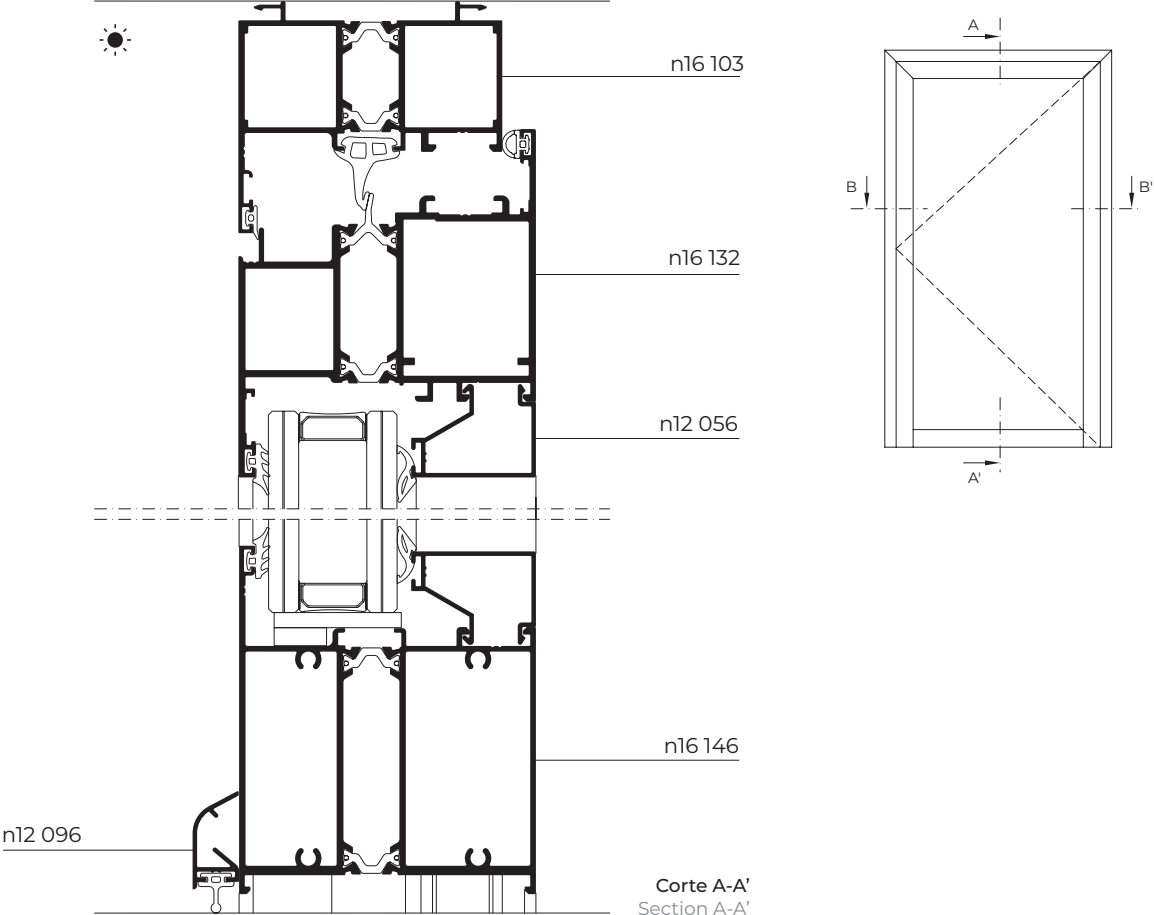



MONTAGENS E TIPOLOGIAS ASSEMBLIES AND TYPOLOGIES

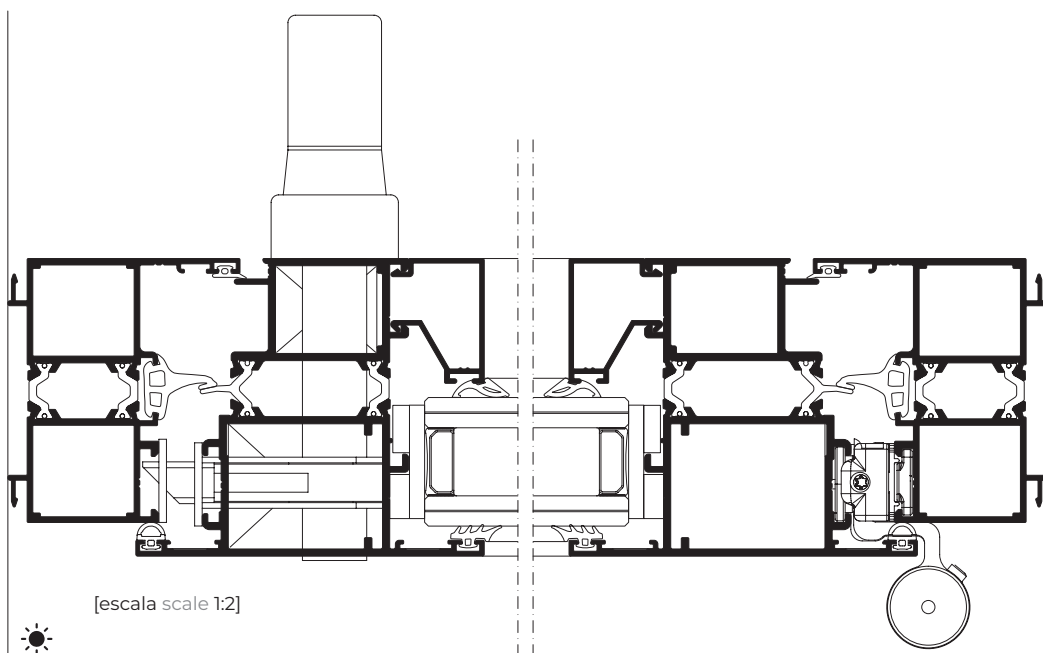
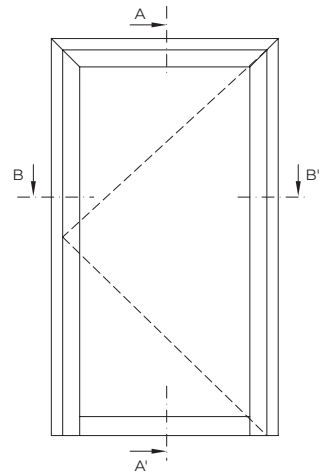
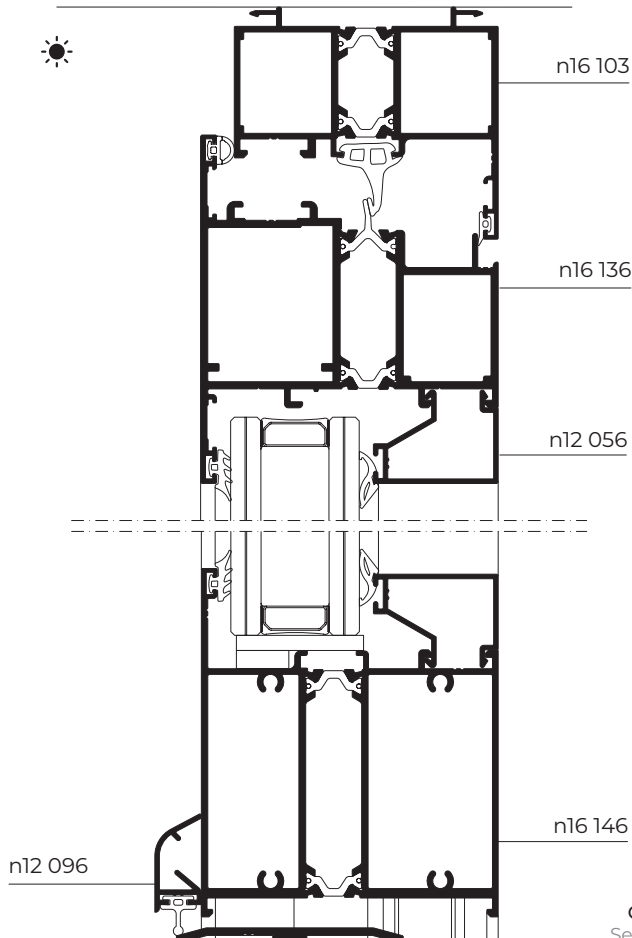

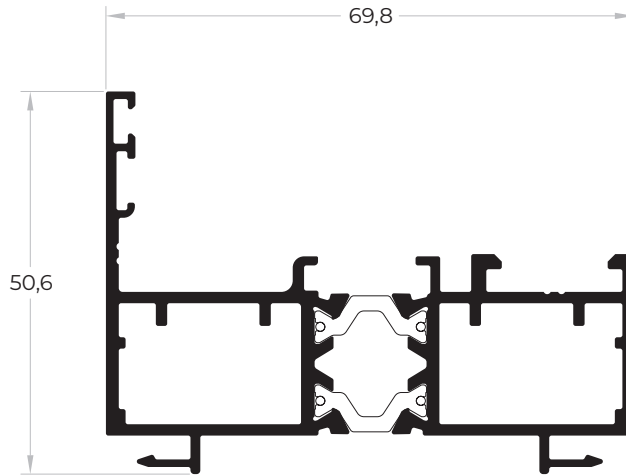

ref: **n16 101**

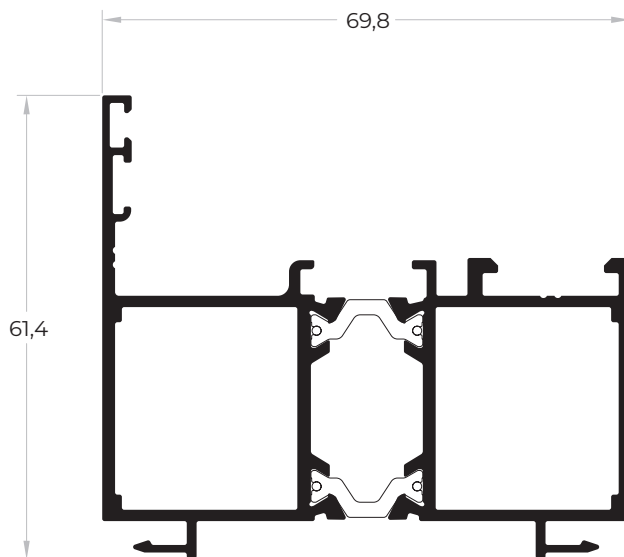

ref: **n16 103**



PERFIS PROFILES

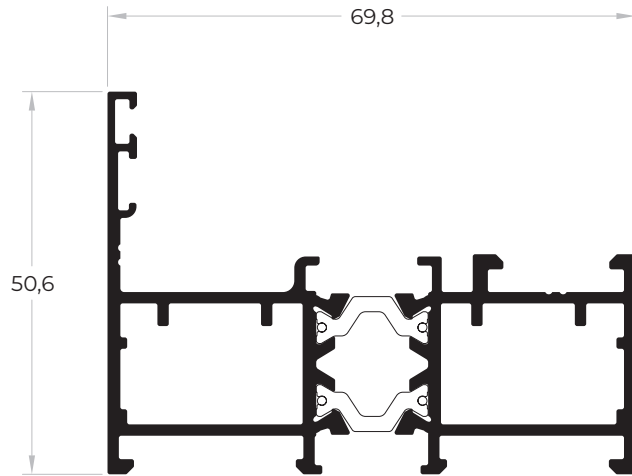

ref: **n16 102**

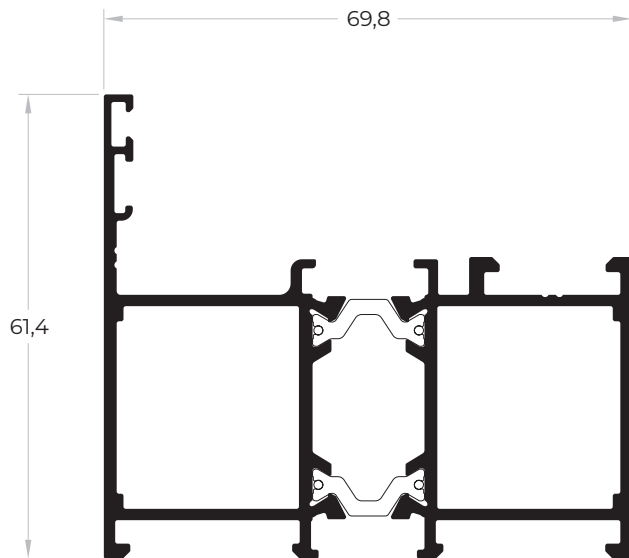

ref: **n16 104**

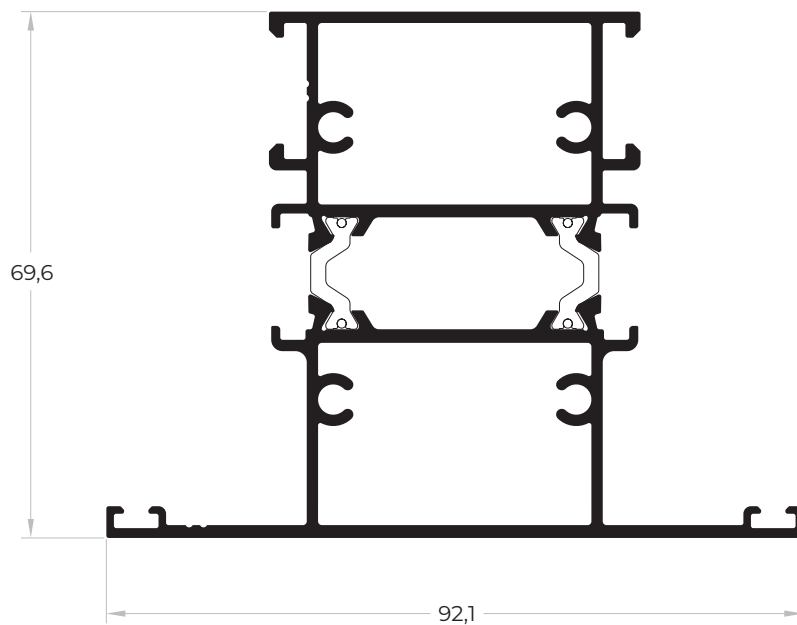

ref: **n16 112**



PERFIS PROFILES

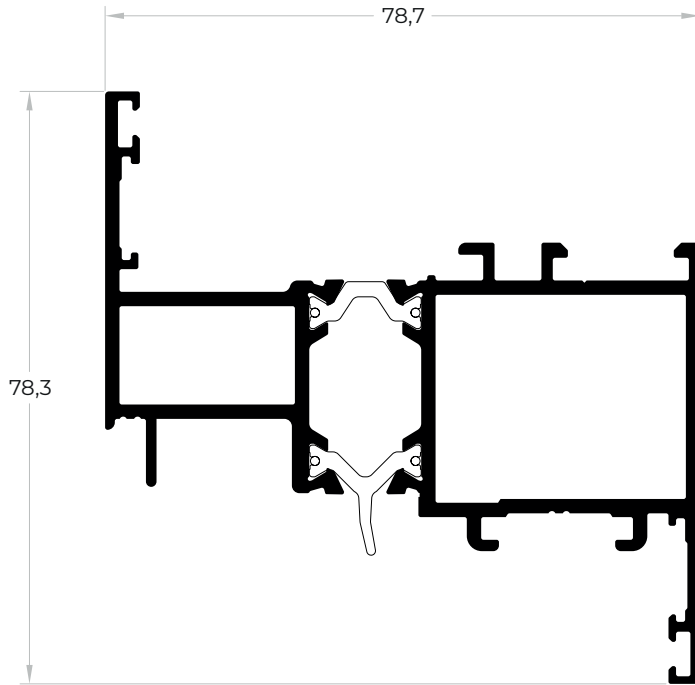

ref: **n16 122**

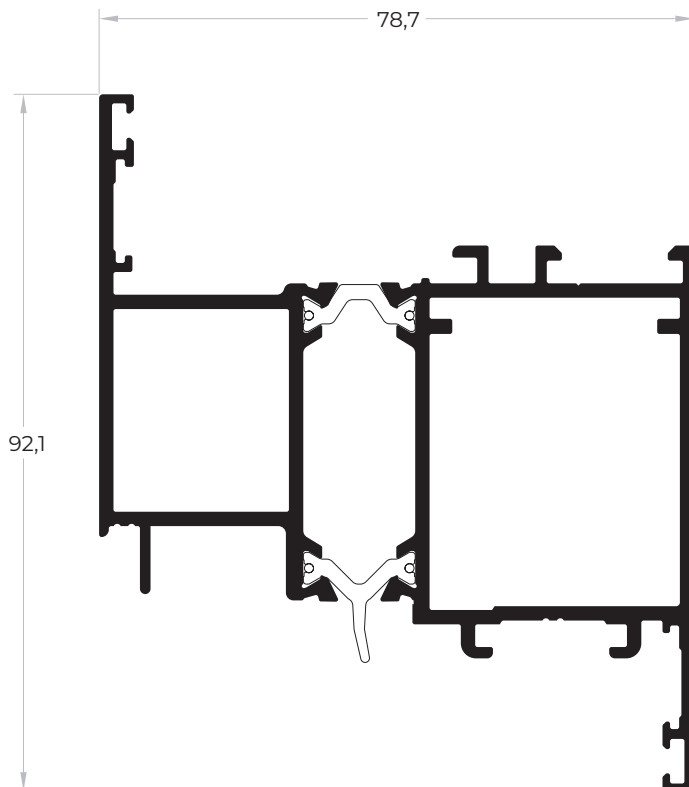

ref: **n16 132**



PERFIS PROFILES

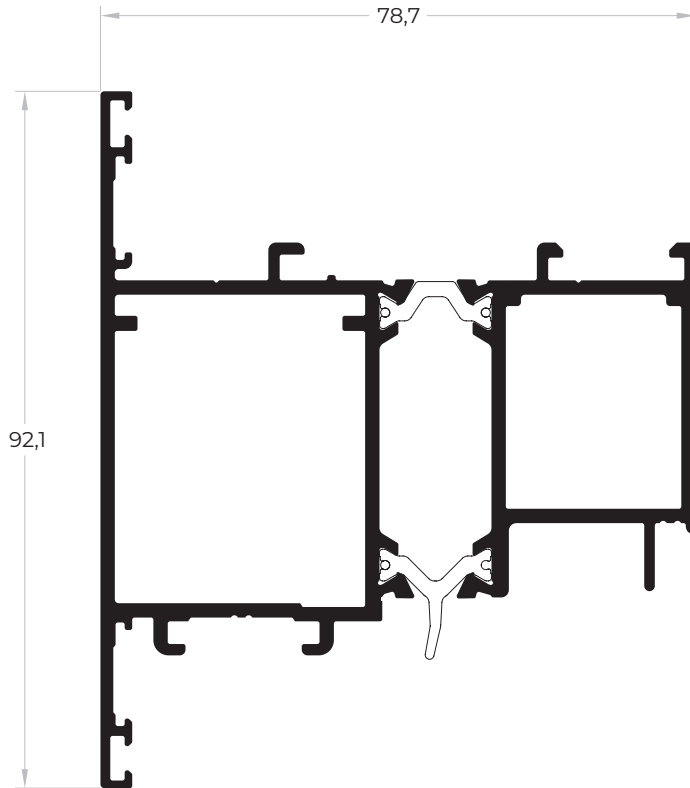

ref: **n16 136**

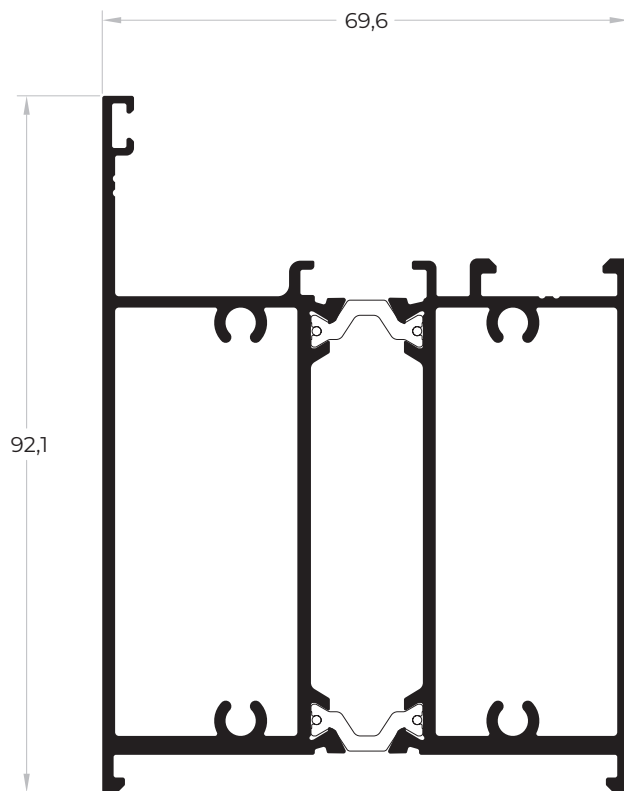

ref: **n16 143**



PERFIS PROFILES

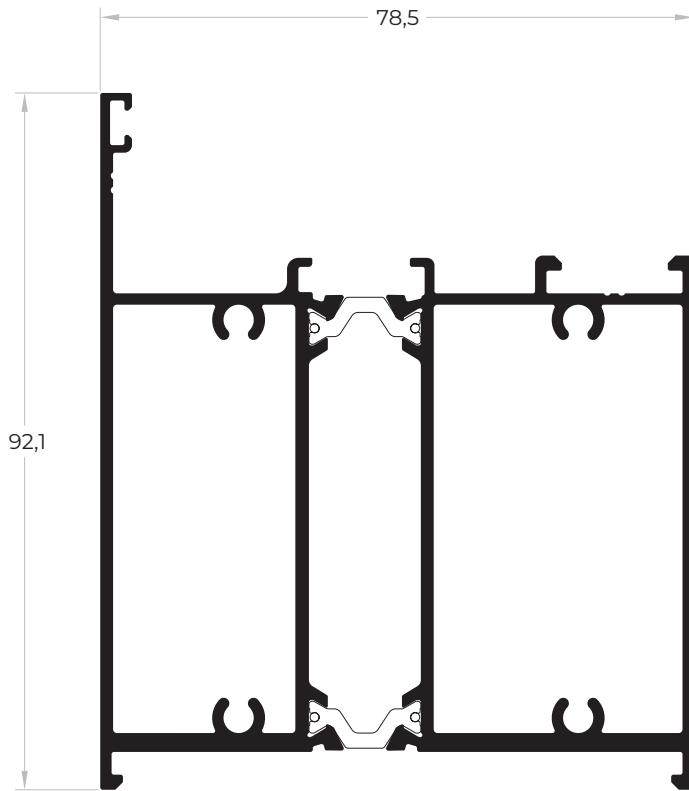

ref: [n16 146](#)

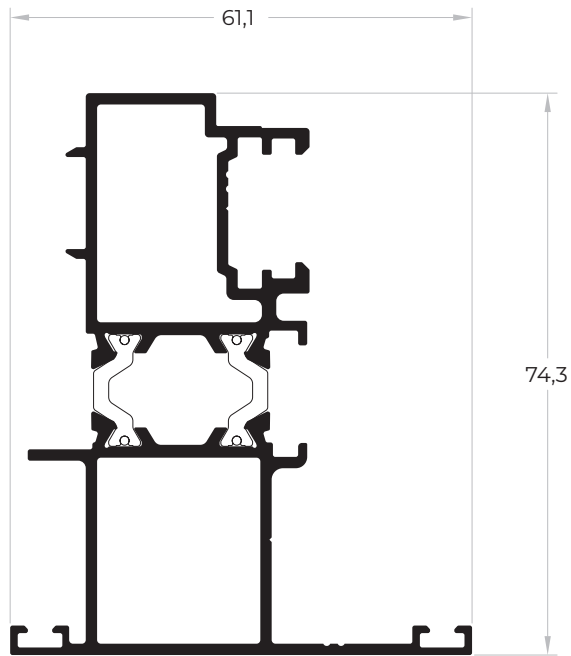

ref: **n16 171**

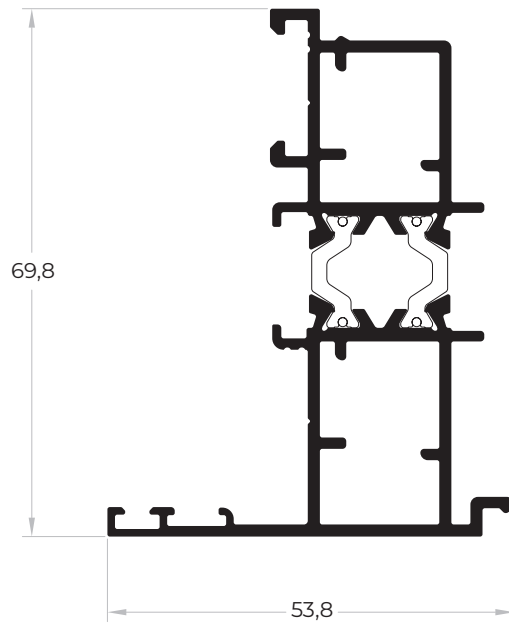

ref: **n16 174**



PERFIS PROFILES

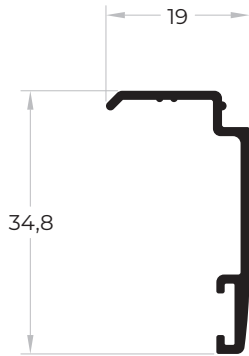

ref: **n14 047**

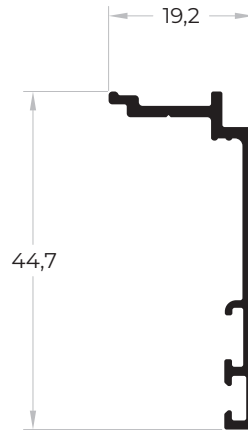

ref: **n14 048**

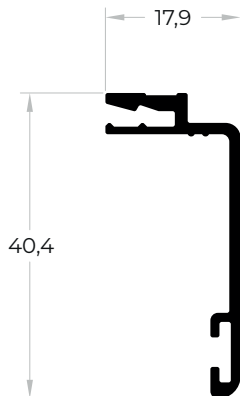

ref: **n14 053**

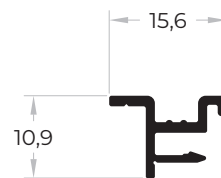

ref: **n14 050**

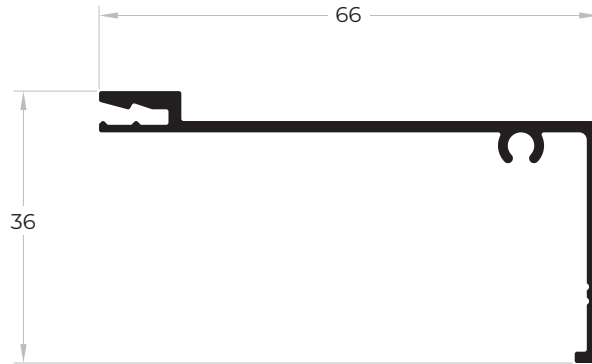

ref: **n14 055**

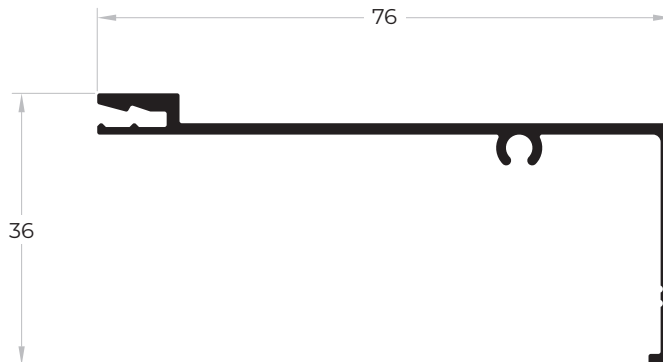

ref: **n14 056**



PERFIS PROFILES

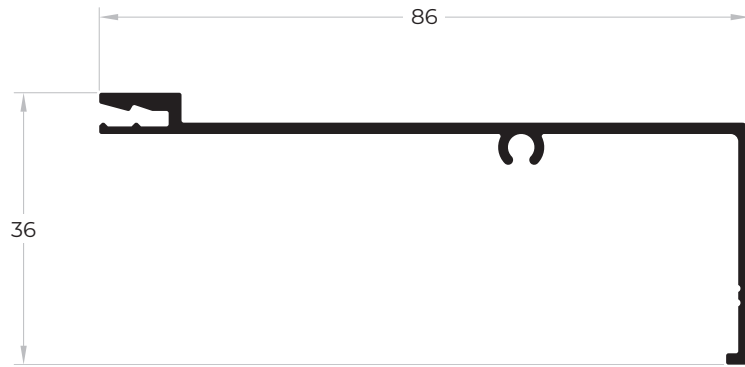

ref: **n14 057**

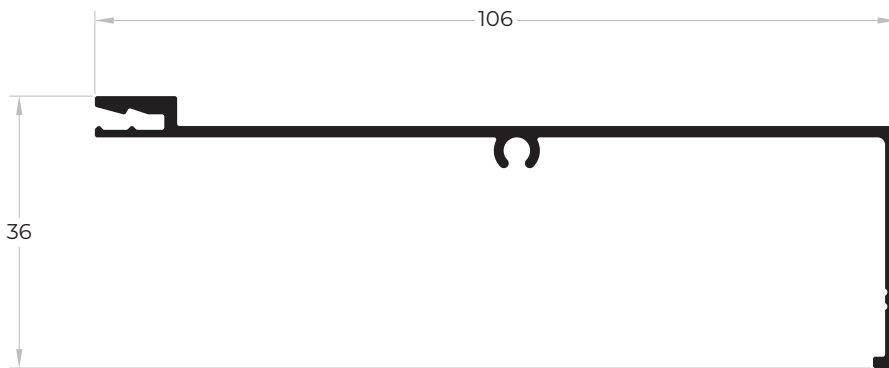

ref: **n14 058**

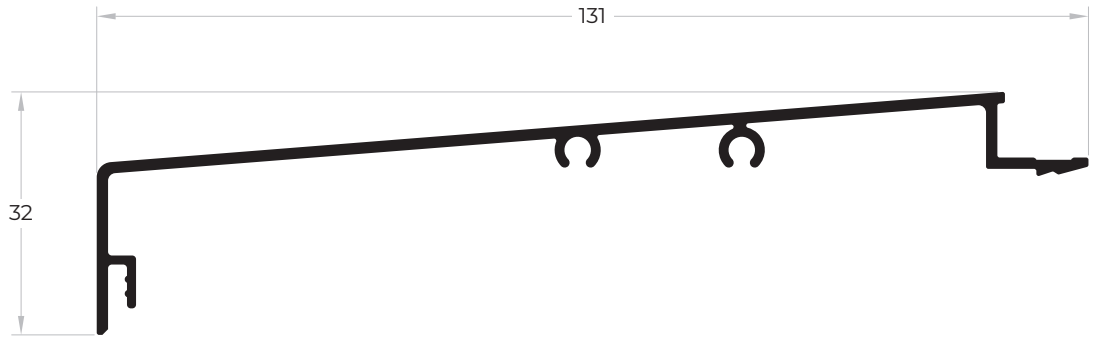

ref: **n14 065**

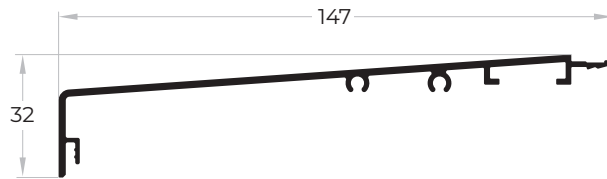

ref: **n14 066**

[escala scale 1:2]



PERFIS PROFILES

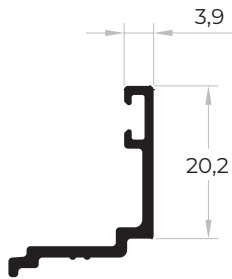

ref: **n12 156**

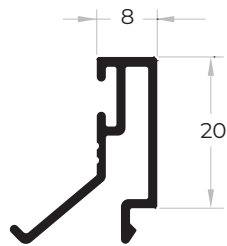

ref: **n12 050**

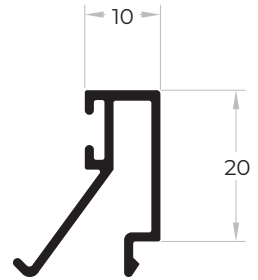

ref: **n12 052**

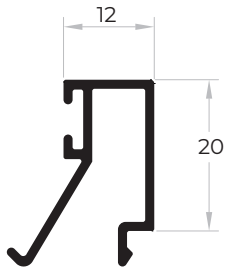

ref: **n12 053**

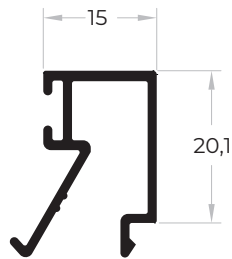

ref: **n12 058**

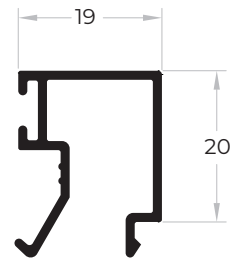

ref: **n12 054**

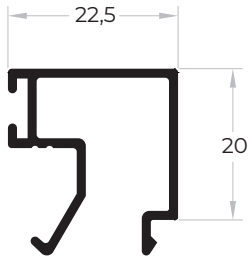

ref: **n12 059**

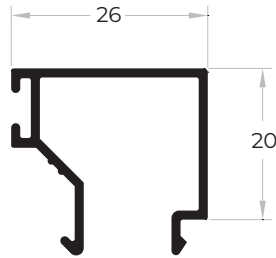

ref: **n12 055**

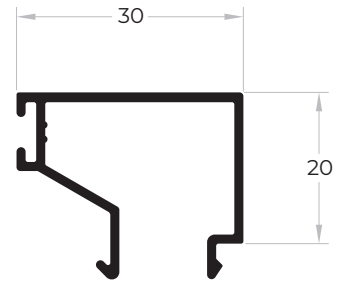

ref: **n12 157**

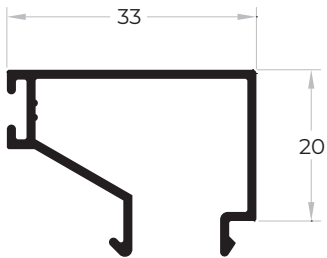

ref: **n12 056**

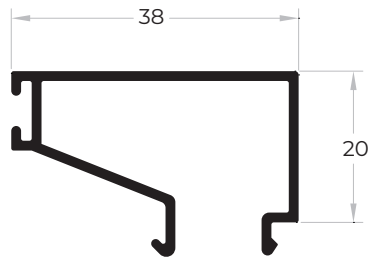

ref: **n12 057**

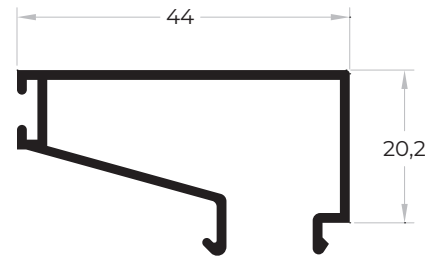

ref: **n12 060**



PERFIS PROFILES

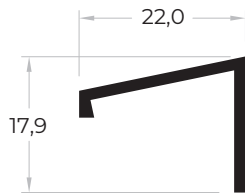

ref: **n10 095**

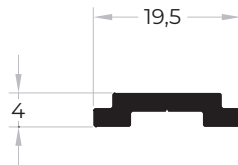

ref: **n12 094**

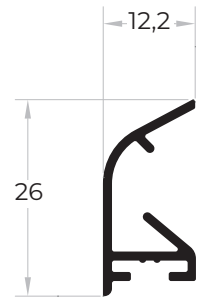

ref: **n12 096**

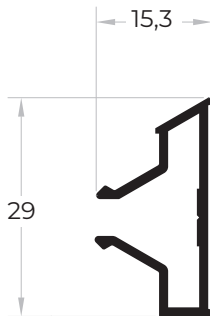

ref: **n12 097**



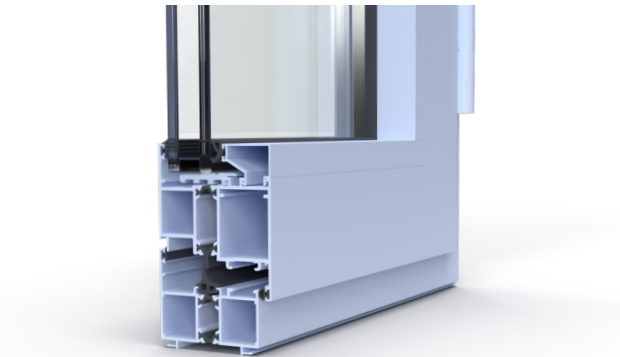
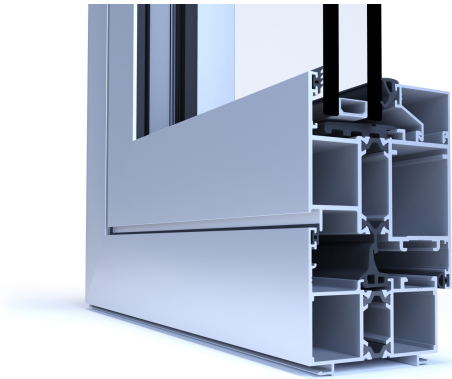

A Navarra - Extrusão de Alumínio, S.A. reserva-se no direito de proceder sem aviso prévio a alterações em todo ou parte do conteúdo apresentado, invalidando todas as versões anteriores.
Navarra - Extrusão de Alumínio, S.A. reserves the right to make unannounced changes to all or part of the content presented, invalidating all previous versions.

EDIFÍCIO SEDE | HEAD OFFICE
SHOWROOM BRAGA | BRAGA SHOWROOM
Navarra - Extrusão de Alumínio, S.A.
Avenida Doutor Domingos Soares, n.º 18
4710-670 Braga

COORDENADAS GPS | GPS COORDINATES
41° 36´ 10.582" N
8° 22´ 52.554" W

ENDEREÇO POSTAL | POSTCODE
Navarra - Extrusão de Alumínio, S.A.
Apartado 2476
4701-971 BRAGA

t. + 351 253 603 520
f. + 351 253 677 005
geral@navarraaluminio.com
comercial@navarraaluminio.com
export@navarraaluminium.com

SHOWROOM LISBOA | LISBON SHOWROOM
Parque das Nações
Alameda dos Oceanos
Edifício Mar do Oriente, n.º63 fração 0.1
1900-137 Lisboa

t. + 351 218 965 032
showroomlisboa@navarraaluminio.com

COORDENADAS GPS | GPS LOCATION
38° 46´ 17.4" N
9° 05´ 44.4" W

Edição 1 | 11/02/26
Edition 1 | 11/02/26